

Self Backey Controller SBC-1

Instruction Manual

(April, 2021)

HIOS Inc. 1-35-1 Oshiage, Sumida-ku Tokyo, Japan 131-0045 TEL: +81-3-6661-8821

ET-A069 21A

This is the controller of Electric tapper SB-400C/SB-650C. It automatically detects excessive load on the tap and the pilot hole, as well as tapper stops itself and returns when the specified depth is achieved.

Parts Name

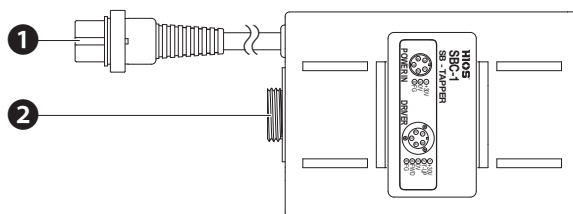

❶ Power Supply Connecting Cord

Connect to power supply.

❷ Screwdriver connector

Connect driver cord with tapper.

Specifications

Dimensions (WxDxH)	70×100×42mm
Weight	153.5g
Compatible Tapper	SB-400C/SB-650C
Compatible Power Supply	T-45BL
Accessories	Bracket×2, Double sided tape×2, Manual×1

Connection and Installation

1 Connect SBC-1 with Power Supply.

- Use joint ring to lock power supply.

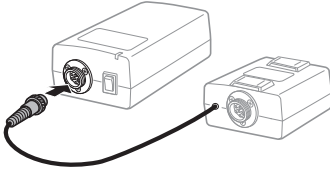

2 Connect Driver Cord with SB Tapper and SBC-1.

- Use joint ring to lock driver cord.

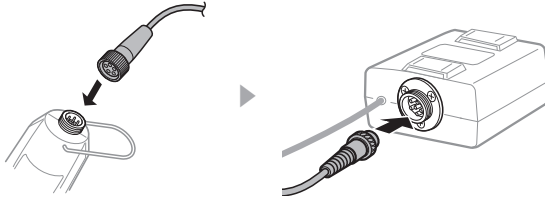

3 Connect power cable with electric outlet, then turn on.

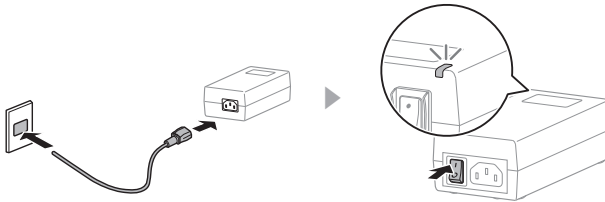

Power Supply Output

Normally, set HI (30V). If you would like a slow RPM, please switch to LOW (20V).

Installation

Either use brackets or double-sided tape.

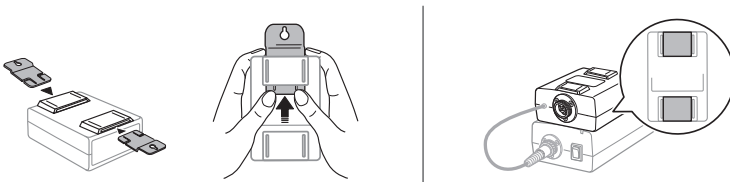

Overload

When overload, it beeps and reverses. Do not release lever until tap is back in the first position.